

Name:		
Location:		
Email:		
Phone:	Cell:	
Fax:	Cover: HL13 HYBRID/KEDER	
Length:	Centers:	Arc: 144'-0"
Rafter Coating: ASTM-A123 Hot Dip Galvanized 3.9 mils Zinc		
Foundation:		

# 120' PROFILE PRO-ADVANTAGE TRUSS

THIS DOCUMENT CONTAINS  
INFORMATION PROPRIETARY TO  
ACCU-STEEL INC. IT SHALL NOT BE  
REPRODUCED, USED, OR DISCLOSED  
WITHOUT PRIOR WRITTEN  
PERMISSION OF ACCU-STEEL INC.



Notes:

Date: 2/23/2012
Project:
Drawn By: JCB
Sales #

**1-877-338-6936**  
[www.asicoverbuildings.com](http://www.asicoverbuildings.com)  
[sales@asicoverbuildings.com](mailto:sales@asicoverbuildings.com)

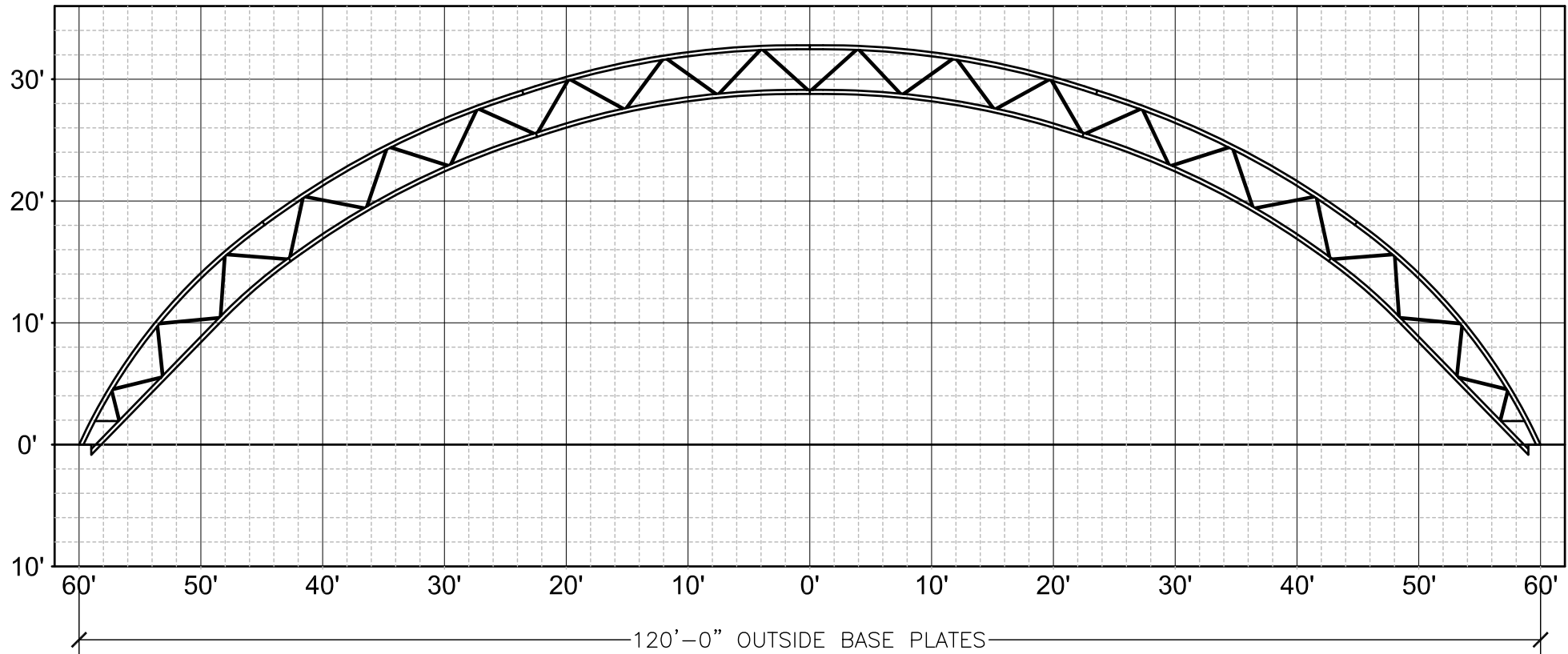

2'x2' GRID